

Route 240

Updated: December 2011

Junction with Route 53 in Soldier Creek Canyon southerly to Route 8, 1947. *Withdrawn* as Route Number 1953.

1966 Description:

From SR-27 (US-50 & 6) south via Hinckley Main Street 1.0 mile, thence east 1.0 mile to SR-140. ***(*A) Scanned* 10/6/66

1967 Legislature:

From Route 27 in Hinckley south via Main Street one mile, thence east to Route 140.

1969 Legislature:

Withdrawn as a State Route by the **1969 Legislature**.

**(B)*

1983 Legislature Description:

From Route 15 east to Route 69 in Honeyville. (Effective May 10, 1983)

1985 Legislature: Description remains the same.

1986 Legislature: Description remains the same.

1987 Legislature: Description remains the same.

1988 Legislature: Description remains the same.

1990 Legislature: Description remains the same.

1992 Legislature: Description remains the same.

1993 Legislature: Description remains the same.

1994 Legislative Description:

From Route 15 east to Route 38 in Honeyville.

1995 Legislature: Description remains the same.

1996 Legislature: Description remains the same.

1997 Legislature: Description remains the same.

1998 Legislature: Description remains the same.

1999 Legislature: Description remains the same.

2000 Legislature: Description remains the same.

2001 Legislature: Description remains the same.

2002 Legislature: Description remains the same.

2003 Legislature: Description remains the same.

2004 Legislature: Description remains the same.

2005 Legislature: Description remains the same.

2006 Legislature: Description remains the same.

2007 Legislature: Description remains the same.

2008 Legislature: Description remains the same.

2011 Legislature: Description remains the same.

Route 240 Cont.

* Refers to resolution index on the following page.

**Refers to Scanned Computer Resolution on the following page.

Route 240

COUNTY/VOLUME & RESOLUTION NUMBER

A. Millard Co. 1/128

B. Box Elder Co. 6/41

DESCRIPTION OF RESOLUTION CHANGE

- | | |
|----------------|--|
| (A).Addition - | From the Jct. With SR-27 (US 50-6), south via Hinckley Main Street, thence east to a Jct. With SR-140. |
| (B).Addition - | From I-15 (Honeyville Inter.) East to Honeyville Jct. SR-69. |

RESOLUTION

State Route 240

WHEREAS, to provide a State Route connection to Hinckley Town via their main street and,

WHEREAS, a resolution was adopted by the Utah State Road Commission on September 23, 1966, recommending the addition to the State System of Highways, that roadway commencing at a junction with State Route 27 (U.S. 50 & 6), south via Hinckley Main Street 1.0 mile, thence east 1.0 mile to a junction with State Route 140.

NOW THEREFORE, pursuant to the Authority of Sec. 27-12-72, UCA, 1953, AS AMENDED, it is hereby resolved as follows:

1. That the roadway commencing at a junction with State Route 27 (U.S. 50 & 6), south via Hinckley Main Street 1.0 mile, thence east 1.0 mile to a junction with State Route 140, be designated as interim State Route 240, subject to the approval of the Legislature.

2. That by this action State Highway System mileage will increase 2.0 miles, Hinckley Town "C" mileage will decrease 1.0 mile and Millard County "B" mileage will decrease 1.0 mile.

3. That Exhibit "A" attached herewith illustrating the action taken herewith is hereby incorporated as a part of this submission.

Dated this 6th day of October, 1966.

STATE ROAD COMMISSION OF UTAH

Clas Strong
Vice Chairman

SR-240
128

Clyde A. Church
Commissioner

Donald W. Ralph
Commissioner

Thomas E. Smith
Commissioner

Commissioner

ATTEST:

Donald A. Zerley
Secretary

SR-240
128

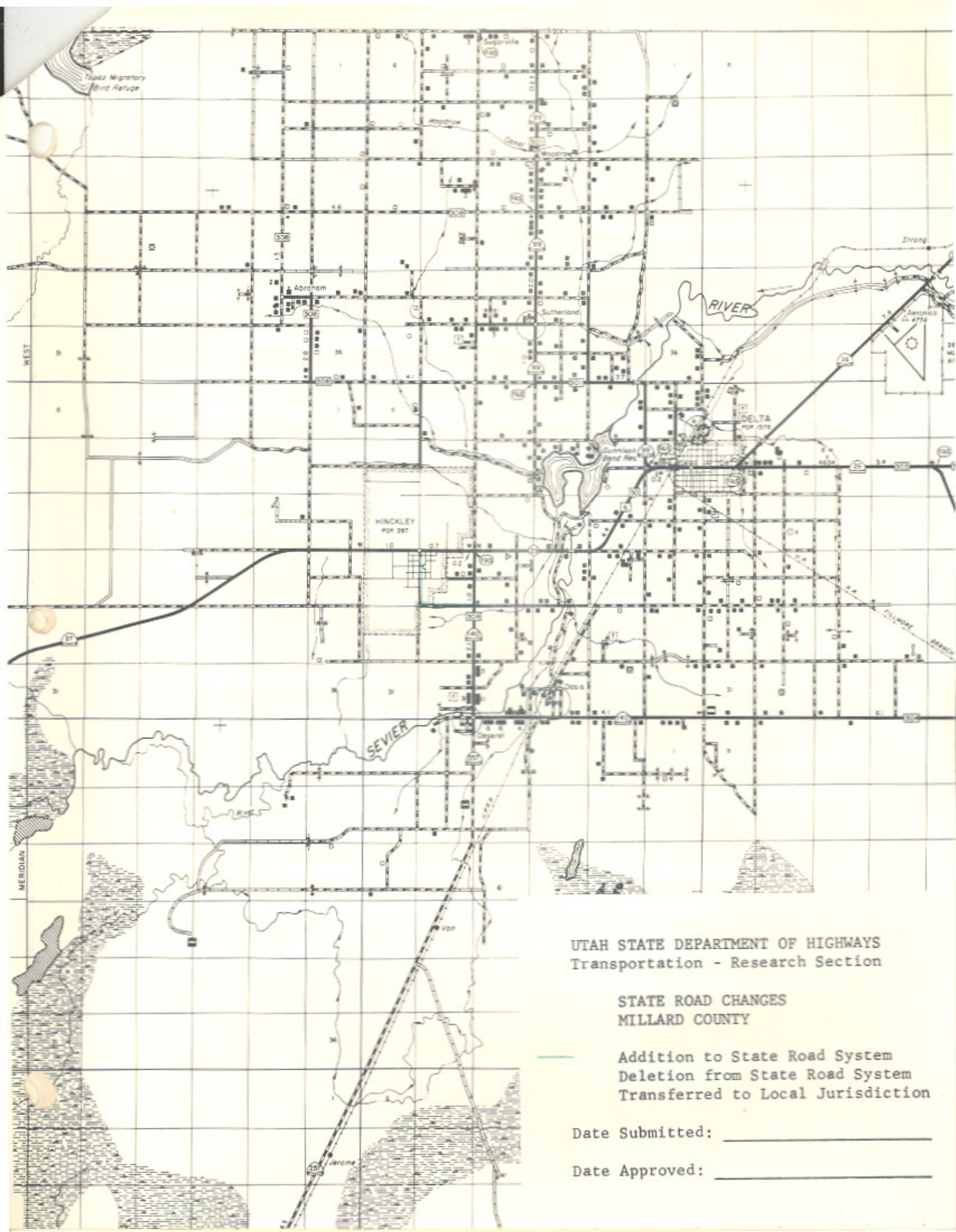

UTAH STATE DEPARTMENT OF HIGHWAYS
 Transportation - Research Section

**STATE ROAD CHANGES
 MILLARD COUNTY**

- Addition to State Road System
- - - Deletion from State Road System
- Transferred to Local Jurisdiction

Date Submitted: _____

Date Approved: _____

RESOLUTION

Addition to the State Highway System
Route 240

Box Elder County

WHEREAS, It has been recommended by the officials of Honeyville Town that a portion of Federal-aid Secondary Route 514 from the on and off ramps on the west side of route 15 east to route 69 in Honeyville be added to the State System of Highways, and

WHEREAS, the addition of this roadway as a state highway is in accord with Utah Code Section 27-12-27, and

WHEREAS, the Utah Transportation Commission concurs in the addition of the aforementioned roadway.

NOW THEREFORE, be it resolved as follows:

1. That the roadway from route 15 at the Honeyville Interchange east to Honeyville be placed on the State Highway System and be designated as route 240, and
2. That by this action the State Highway System will increase 1.25 + miles, and
3. That the accompanying map be hereby incorporated as a part of this resolution.

Dated this 15th day of October, 1982.

UTAH TRANSPORTATION COMMISSION

B. LaSalle Cox
Chairman

Vice-Chairman

Commissioner

ATTEST:

Ilva H. Anderson
Secretary

Samuel P. Davis
Commissioner

Charles B. [Signature]
Commissioner

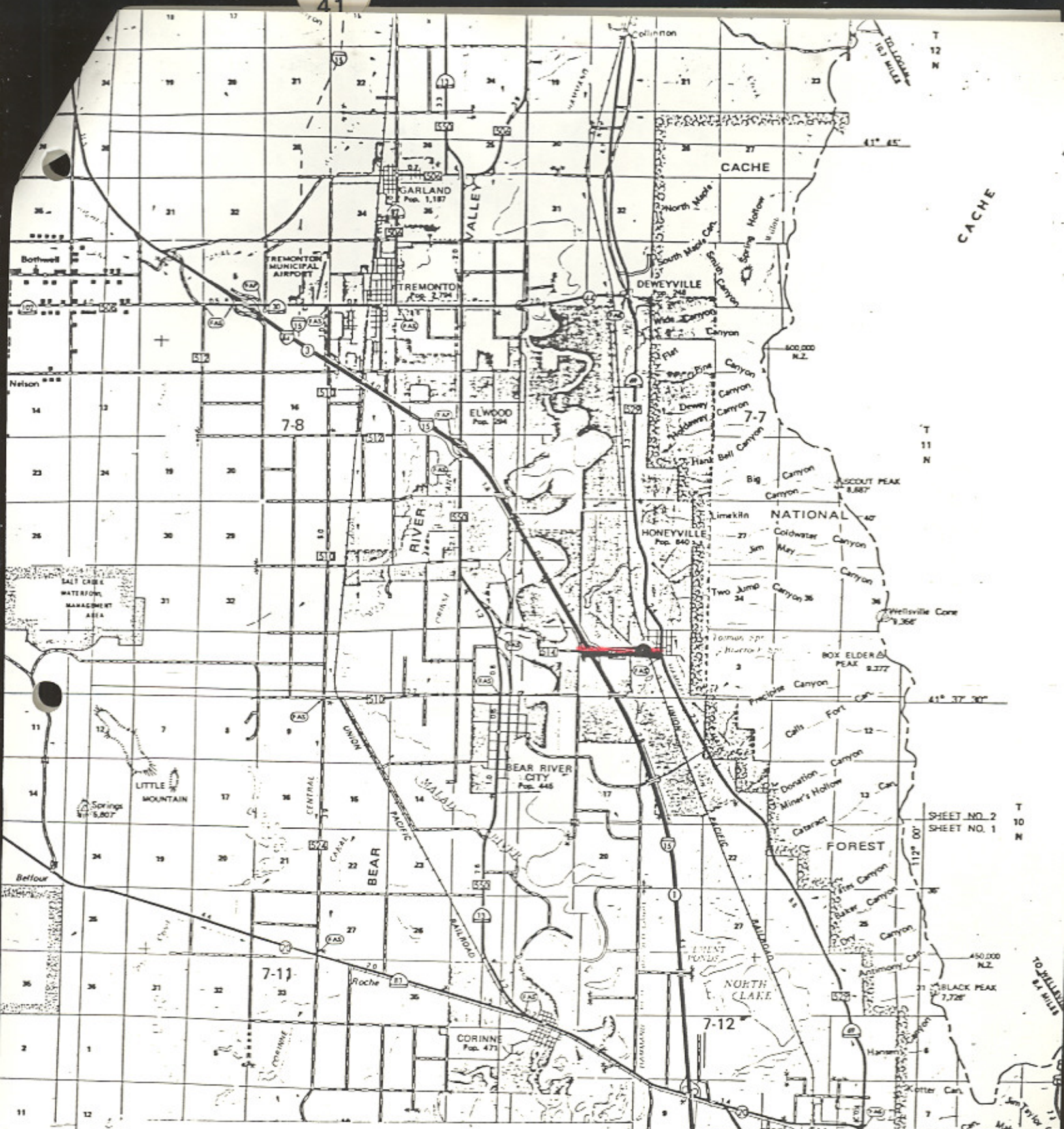

Utah Department of Transportation
 Transportation Planning Division
 Addition to State Highway System
Box Elder County



Addition
 Proposed Designation

SHEET NO. 2
 SHEET NO. 1

450,000
 N.L.
 BLACK PEAK
 7,728'

BRIGHAM CITY
 Pop. 14,000

PERRY
 Pop. 100